

Full Bore Magflowmeter for Continuous or Batch Control

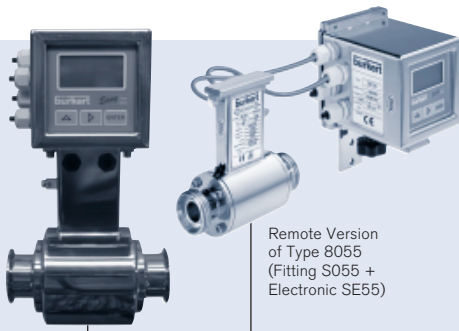

Sanitary Version of Type 8055 (Fitting S055 + Electronic SE55)

Remote Version of Type 8055 (Fitting S055 + Electronic SE55)

Type 8055 can be combined with...

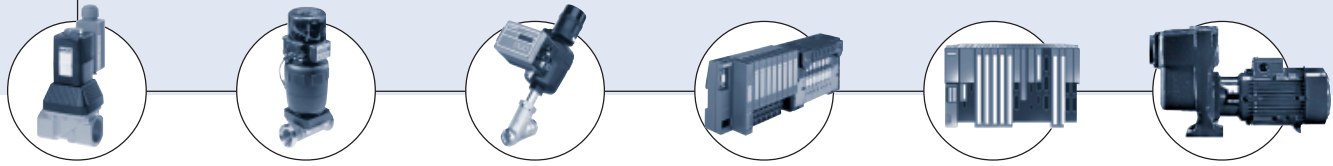

Type 6223

Solenoid Control Valve

Type 2731

TOP Control

Type 2700

SIDE Control

Type 8644

AirLINE

PLC

Pumps

- Large graphic display
- Batch function integrated for filling and dosing operations, incl. data registration
- Sanitary versions for food & beverage applications
- CIP (clean in place)
- Remote or Compact Mounting

The full bore magmeter 8055 with large graphic display is designed for applications with a minimum conductivity of 5 µS/cm. Type 8055 can be programmed locally with 3 key pads or by computer with a serial interface RS485.

Combined with a valve as the actuating element, Type 8055 can control high-precision dosing and filling operations. In the standard version the equipment is supplied with two transistor outputs, current output 0/4-20mA and RS485. The transistor outputs are individually freely programmable and can be configured as pure switching outputs for valves, alarm, rough/fine dosage or in addition, proportionally to flow rate/volumes as pulse output (max. 1250 Hz).

On request the equipment can be equipped with further outputs and also with real-time clock and data logger.

Type 8055 consists of a fitting S051 (low flow), S055 (general purpose) or S056 (sanitary) and the electronic SE55.

Burkert Contromatic USA

2602 McGaw Avenue
Irvine, CA 92614
Tel. 949.223.3100
Fax 949.223.3198
www.burkert-usa.com

Burkert Contromatic Inc.

760 Pacific Road, Unit 3
Oakville, Ontario, Canada L6L 6M5
Tel. 905.847.5566
Fax 905.847.9006
www.burkert.ca

Technical Data	
Orifice (DN)	
Sanitary	1/8" up to 4" (3mm up to 100mm)
Low flow	1/8" up to 3/4" (3mm up to 20mm)
General purpose	1" up to 4" (25mm up to 100mm)
Measuring range	
Sanitary	0 – 1.1 gpm up to 0 – 1233 gpm (others on request)
Low flow	0 – 1.1 gpm up to 0 – 55 gpm
General purpose	0 – 79 gpm up to 0 – 1233 gpm
Accuracy	± 0.2% of Reading (for liquid velocity > 3 ft/s)
Repeatability	better than 0.1%
Minimum conductivity	5 µS/cm
Process connection	
Sanitary* (*surface finish Ra<0.8µm)	Tri-Clamp® (ASME BPE) (others on request)
Low flow	Threaded Male NPT or ANSI Flange 150 RF (others on request)
General purpose	Flanged ANSI 150 RF (others on request)
Body materials	
Sanitary sensor	Stainless Steel 304 (Stainless Steel 316 on request)
Low flow sensor	Stainless Steel 316L
General purpose sensor	Carbon Steel varnished (Stainless Steel 304 on request)
Controller	Carbon Steel varnished or St. Steel 304
Wetted parts	Stainless Steel 316L (others on request)
Lining material	
Sanitary	PTFE
Low flow	PTFE
General purpose	Polypropylene (PTFE on request)
Sample Rate	50 Hz

Electrical Specifications

Electrical specifications	
Voltage supply	90–265 VAC, 18–36 VDC (others on request)
Outputs	
Current	1 output 0/4 - 20mA
Transistor	2 output (40VDC, 100mA)
Pulse	transistor output, DC squarewave, <100V, configurable max. 1250Hz
Serial interface	RS485
Input	1 Digital input (0 up to 40 VDC)
Electrical connections	Terminal blocks
Optional features on request:	
Current	1 output 0/4 - 20mA
Relays	2 outputs (250VAC/2A)
Transistor	2 outputs (40VDC, 100mA)
Pulse	transistor output configurable max. 1250Hz
Clock	1 real-time clock
Data logger	8MB

Environment specifications	
Fluid temperature range	
PTFE lining	-4°F – 302°F
PP lining	32°F – 140°F
Ambient temperature range	-4°F – 140°F
Fluid pressure max.	230 PSI
Enclosure	
Sensor	IP68
Controller	IP67

Standards	
EMI	EN55011 (Group 1, Class B) IEC 1000-4-2/3/4/5/6/11
Safety	EN61010

Target Markets

Continuous and Batch Control

- Water treatment
- Food & beverage
- High purity:
 - Pharmaceutical
 - Medical

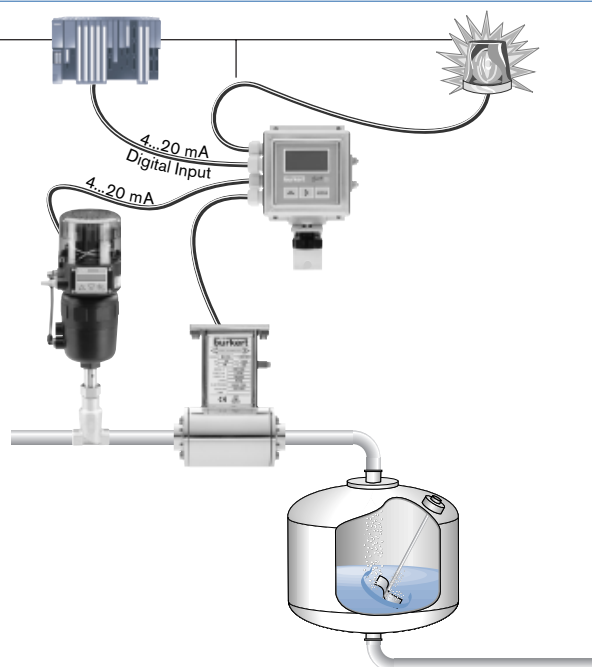

Ordering chart for Compact 8055

Display and Electronic Type SE55 – for Fitting Type S0XX (below)

Voltage supply	Input	Output	Serial interface	Material	Item no.
90-265 VAC	1 Digital	0/4...20 mA, 2 transistors, pulse (1250) Hz	RS 485	SS 304	553 478 B
90-265 VAC	1 Digital	0/4...20 mA, 2 transistors, pulse (1250) Hz	RS 485	Carbon Steel varnished	553 091 W
18-63 VDC	1 Digital	0/4...20 mA, 2 transistors, pulse (1250) Hz	RS 485	SS304	552 424 L

Note: The Compact 8055 Transmitter consists of an electronic SE55, and a fitting S051, S055 or S056. See below. Components have to be ordered separately!

Stainless Steel Fitting Type S051 – Low Flow Version (Male Threads)

Orifice (DN)	Process connection (NPT male)	Flow rate – range [gpm]	Body material	Wetted parts	Lining material	Item no.
1/8" (3)	NPT 1/4"	0 – 1.1	SS 304	SS 316L	PTFE	554 213 S
1/4" (6)	NPT 3/8"	0 – 4.4	SS 304	SS 316L	PTFE	US09259
3/8" (10)	NPT 1/2"	0 – 13.3	SS 304	SS 316L	PTFE	US09260
1/2" (15)	NPT 3/4"	0 – 26.4	SS 304	SS 316L	PTFE	US09261
3/4" (20)	NPT 1"	0 – 55.0	SS 304	SS 316L	PTFE	553 663 C

Stainless Steel Fitting Type S055 – General Purpose Version ANSI Flanges

Orifice (DN)	Process connection (ANSI 150 RF)	Flow rate – range [gpm]	Body material	Wetted parts	Lining material	Item no.
1" (25)	1"	0 – 79.0	Carbon Steel varnished	SS 316L	PP	554 353 E
1 1/4" (32)	1 1/4"	0 – 128.0	Carbon Steel varnished	SS 316L	PP	US09264
1 1/2" (40)	1 1/2"	0 – 198.0	Carbon Steel varnished	SS 316L	PP	US09265
2" (50)	2"	0 – 317.0	Carbon Steel varnished	SS 316L	PP	554 354 F
2 1/2" (65)	2 1/2"	0 – 528.0	Carbon Steel varnished	SS 316L	PP	US09267
3" (80)	3"	0 – 793.0	Carbon Steel varnished	SS 316L	PP	554 351 C
4" (100)	4"	0 – 1233.0	Carbon Steel varnished	SS 316L	PP	554 352 D

Stainless Steel Fitting Type S056 – Sanitary Version (ASME BPE Tri-Clamp)

Orifice (DN)	Process connection (Tri-Clamp fitting)	Flow rate – range [gpm]	Body material	Wetted parts	Lining material	Item no.
1/8" (3)	1/2"	0 – 1.1	SS 304	SS 316L	PTFE	US09270
1/4" (6)	1/2"	0 – 4.4	SS 304	SS 316L	PTFE	553 325 Z
3/8" (10)	1/2"	0 – 13.2	SS 304	SS 316L	PTFE	US09271
1/2" (15)	3/4"	0 – 26.4	SS 304	SS 316L	PTFE	553 533 J
3/4" (20)	1"	0 – 55.0	SS 304	SS 316L	PTFE	553 534 K
1" (25)	1"	0 – 79.0	SS 304	SS 316L	PTFE	553 535 L
1 1/2" (40)	1 1/2"	0 – 198.0	SS 304	SS 316L	PTFE	553 536 M
2" (50)	2"	0 – 317.0	SS 304	SS 316L	PTFE	553 537 N
2 1/2" (65)	2 1/2"	0 – 528.0	SS 304	SS 316L	PTFE	553 538 X
3" (80)	3"	0 – 793.0	SS 304	SS 316L	PTFE	US09272
4" (100)	4"	0 – 1233.0	SS 304	SS 316L	PTFE	US09273

Ordering chart for Remote 8055

Display and Electronic Type SE55 – for Fitting Type S0XX (below)

Voltage supply	Input	Output	Serial interface	Material	Item no.
90-265 VAC	1 Digital	0/4...20 mA, 2 transistors, pulse (1250 Hz)	RS 485	SS 304	448 478 S
90-265 VAC	1 Digital	0/4...20 mA, 2 transistors, pulse (1250 Hz)	RS 485	Carbon Steel varnished	448 479 K
18-63 VDC	1 Digital	0/4...20 mA, 2 transistors, pulse (1250 Hz)	RS 485	SS304	552 460 C

Note: The Remote 8055 Transmitter consists of an electronic SE55, and a fitting S051, S055 or S056. Two 30 foot connection cables (coil + electrodes) included with fitting. See below. Components have to be ordered separately!

Ordering chart for Fitting Type S056

Stainless Steel Fitting Type S051 – Low Flow Version (Male Threads)

Orifice (DN)	Process connection (NPT male)	Flow rate – range [gpm]	Body material	Wetted parts	Lining material	Item no.
1/8" (3)	NPT 1/4"	0 – 1.1	SS 304	SS 316L	PTFE	US09274
1/4" (6)	NPT 3/8"	0 – 4.4	SS 304	SS 316L	PTFE	US09275
3/8" (10)	NPT 1/2"	0 – 13.3	SS 304	SS 316L	PTFE	US09276
1/2" (15)	NPT 3/4"	0 – 26.4	SS 304	SS 316L	PTFE	US09277
3/4" (20)	NPT 1"	0 – 55.0	SS 304	SS 316L	PTFE	US09278

Stainless Steel Fitting Type S055 – General Purpose Version (Flanges)

Orifice (DN)	Process connection (ANSI 150 RF)	Flow rate – range [gpm]	Body material	Wetted parts	Lining material	Item no.
1" (25)	1"	0 – 79.0	Carbon Steel varnished	SS 316L	PP	US09279
1 1/4" (32)	1 1/4"	0 – 128.0	Carbon Steel varnished	SS 316L	PP	US09280
1 1/2" (40)	1 1/2"	0 – 198.0	Carbon Steel varnished	SS 316L	PP	US09281
2" (50)	2"	0 – 317.0	Carbon Steel varnished	SS 316L	PP	US09282
2 1/2" (65)	2 1/2"	0 – 528.0	Carbon Steel varnished	SS 316L	PP	US09283
3" (80)	3"	0 – 793.0	Carbon Steel varnished	SS 316L	PP	553 795 Z
4" (100)	4"	0 – 1233.0	Carbon Steel varnished	SS 316L	PP	US09285

Stainless Steel Fitting Type S056 – Sanitary Version

Orifice (DN)	Process connection (Tri-Clamp fitting)	Flow rate – range [gpm]	Body material	Wetted parts	Lining material	Item no.
1/8" (3)	1/2"	0 – 1.1	SS 304	SS 316L	PTFE	US09286
1/4" (6)	1/2"	0 – 4.4	SS 304	SS 316L	PTFE	US09287
3/8" (10)	1/2"	0 – 13.2	SS 304	SS 316L	PTFE	US09288
1/2" (15)	3/4"	0 – 26.4	SS 304	SS 316L	PTFE	554 082 K
3/4" (20)	1"	0 – 55.0	SS 304	SS 316L	PTFE	US09290
1" (25)	1"	0 – 79.0	SS 304	SS 316L	PTFE	US09291
1 1/2" (40)	1 1/2"	0 – 198.0	SS 304	SS 316L	PTFE	554 147 Y
2" (50)	2"	0 – 317.0	SS 304	SS 316L	PTFE	554 138 X
2 1/2" (65)	2 1/2"	0 – 528.0	SS 304	SS 316L	PTFE	US09294
3" (80)	3"	0 – 793.0	SS 304	SS 316L	PTFE	US09295
4" (100)	4"	0 – 1233.0	SS 304	SS 316L	PTFE	US09296

Accessories

Connection cable for separate version

Description	Item no.
Electrodes cable 30', type C015 for connection between MS sensor/ML converter, Poliolefina insulation (only for remote version)	448 518 A
Coils cable 30', type C016 for connection between MS sensor/ML converter, Poliolefina insulation (only for remote version)	448 519 B

Note: Connection cables included with Remote version fitting.

Dimensions [mm] Electronic Type SE55

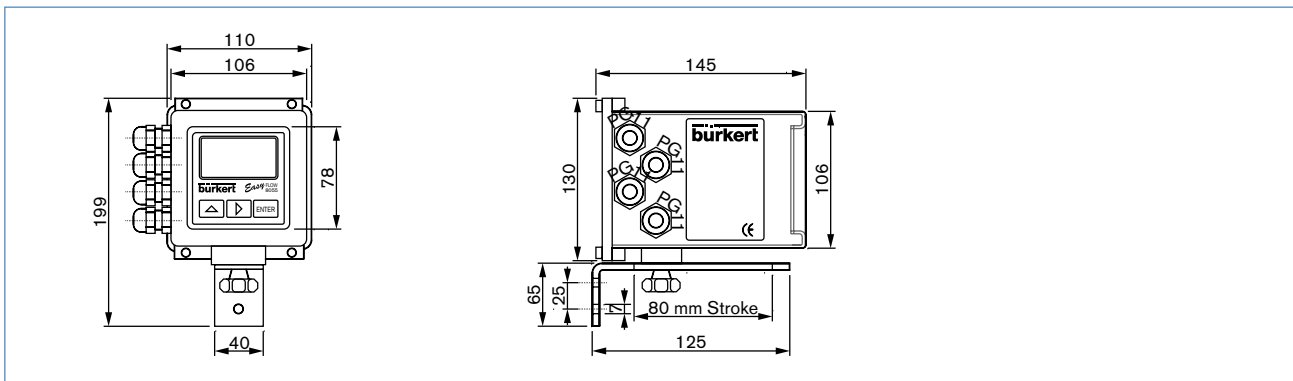

Dimensions- Fitting Type S051 Low Flow ANSI Flange 150 RF

ANSI Flange Fittings (PTFE Lining)

Orifice (DN)	D (mm)	H (mm)
1/8" (3)	3.5" 88.9	7.20" (183)
1/4" (6)	3.5" 88.9	7.20" (183)
3/8" (10)	3.5" 88.9	7.20" (183)
1/2" (15)	3.5" 88.9	7.20" (183)
3/4" (20)	3.87" 98.4	7.37" (188)

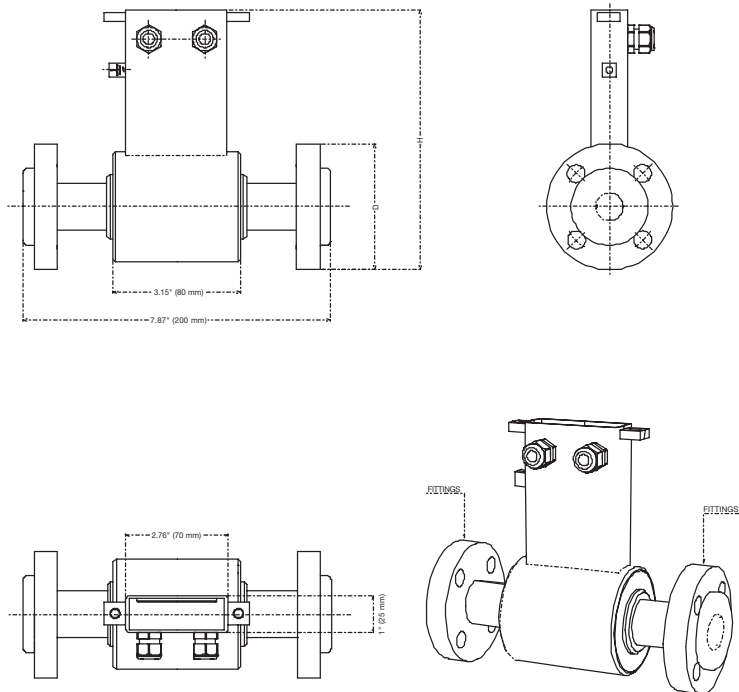

Dimensions- Fitting Type S051 Low Flow (Threaded Male NPT)

Fittings NPT (PTFE Lining)

Orifice (DN)	Port Connection (Male)
1/8" (3)	1/4"
1/4" (6)	3/8"
3/8" (10)	1/2"
1/2" (15)	3/4"
3/4" (20)	1"

Ordering chart for Fitting Type S056

ANSI 150				ANSI 300			
Orifice (DN)	L	H	D	Orifice (DN)	L	H	D
1" (25)	200	181	108	1" (25)	200	190	124
1 1/4" (32)	200	192	118	1 1/4" (32)	200	199	133
1 1/2" (40)	200	207	127	1 1/2" (40)	200	221	156
2" (50)	200	222	152	2" (50)	200	228	165
2 1/2" (65)	200	245	178	2 1/2" (65)	200	251	191
3" (80)	200	259	191	3" (80)	200	268	210
4" (100)	250	288	229	4" (100)	250	300	254

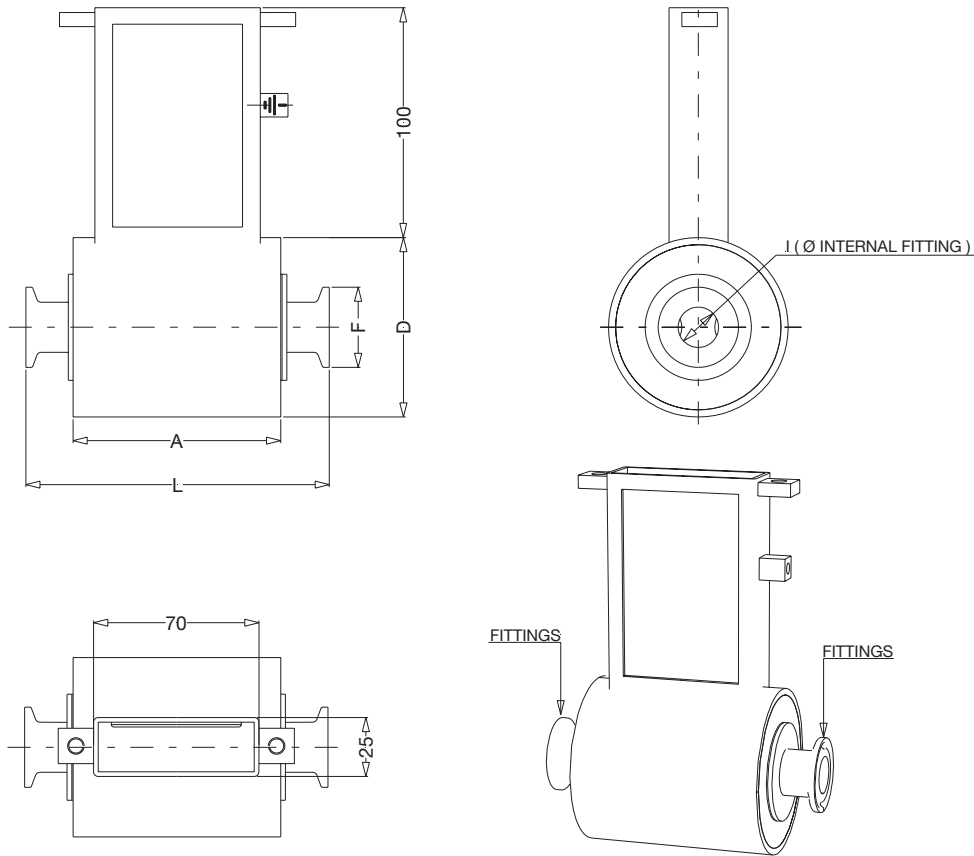
Dimensions- Fitting Type S051 Tri-Clamp®

Tri-Clamp® Fittings ASME BPE

Orifice (DN)	A (mm)	L (mm)	D (mm)	I (mm)	F (mm)
1/8" (3)	3.03" (77)	5.04" (128)	3" (76)	0.37" (9.5)	1" (25.4)
1/4" (6)	3.03" (77)	5.04" (128)	3" (76)	0.37" (9.5)	1" (25.4)
3/8" (10)	3.03" (77)	5.04" (128)	3" (76)	0.37" (9.5)	1" (25.4)
1/2" (15)	3.03" (77)	5.04" (128)	3" (76)	0.62" (15.85)	1" (25.4)
3/4" (20)	3.03" (77)	5.04" (128)	3" (76)	0.87" (22.2)	1.99" (50.5)
1" (25)	3.94" (100)	7.09" (180)	3" (76)	0.87" (22.2)	1.99" (50.5)
1 1/2" (40)	3.94" (100)	7.09" (180)	3.50" (89)	1.37" (34.9)	1.99" (50.5)
2" (50)	3.94" (100)	7.09" (180)	4.49" (114)	1.87" (47.6)	2.52" (64)
2 1/2" (65)	3.94" (100)	7.09" (180)	5.51" (140)	2.37" (60.3)	3.05" (77.4)
3" (80)	3.94" (100)	7.87" (200)	5.51" (140)	2.87" (73)	3.58" (91)
4" (100)	3.94" (100)	7.87" (200)	6.61" (168)	3.84" (97.6)	4.69" (119)

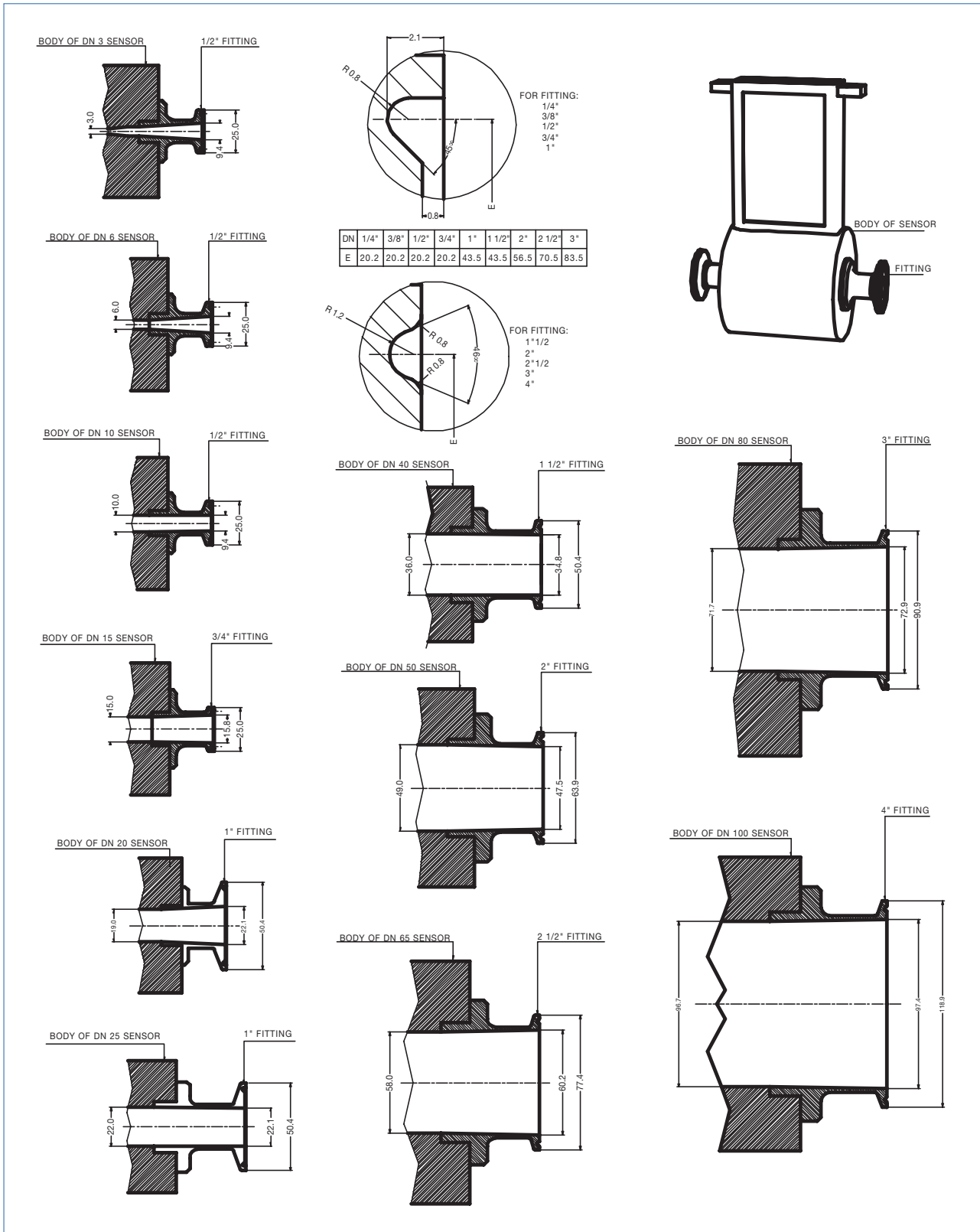
Dimensions [mm] Fitting Type S056 Sanitary Tri-Clamp®



In case of special application conditions, please consult for advice.

We reserve the right to make technical changes without notice.

US_8055_2/05_C